



## 7 La Place Le Couteur La Rue Horman

Grouville, Jersey, JE3 9GW

Asking price £319,000



FIRST TIME BUYERS ONLY - We are delighted to offer you this very light & airy first floor / top floor apartment located in the highly sought after area of Gorey Village. The apartment is an ideal step on to the property ladder and briefly comprises of a good sized kitchen, dual aspect lounge / diner, spacious double bedroom and house bathroom with frosted window. The property also benefits from a communal paved area ideal for relaxing & entertaining, 2 large storage cupboards and designated parking for 1 car. Ideally situated within the village all the local bars, cafes, restaurants & convenience stores are just a short stroll away and the nearest Coop just a short drive away. The popular Number 1 & Number 1A bus route is also within easy walking distance. Viewing is highly recommended.





Entrance Hall

Light & airy entrance hall with two windows overlooking communal areas. Doors to all rooms plus utility cupboard plumbed for washing machine. Wood effect flooring & recessed lighting. Access to loft space.

Kitchen 11'9" x 6'9" (3.6 x 2.08)

Range of high and low kitchen units with laminate worktops and tiled splashbacks. Standalone appliances including a double oven with hobs above, dishwasher and fridge freezer. Window overlooking communal areas, vinyl tile effect flooring & recessed lighting.

Lounge 15'11" x 10'5" (4.863 x 3.2)

Light & airy dual aspect lounge with wood effect flooring & recessed lighting.

Bedroom 12'9" x 8'7" (3.9 x 2.62)

Double bedroom laid to carpet with two windows overlooking communal area. Recessed lighting.

Bathroom 11'9" x 6'2" (3.6 x 1.9)

Fully tiled walls & floor. Bath with shower over and screen, WC, wash hand basin with cupboards below and mirrored cupboard above & heated towel rail. Cupboard housing emersion cylinder & recessed lighting. Frosted window.

Exterior

Communal paved area ideal for relaxing & entertaining

Parking

Designated parking for 1 car

Services

All mains excluding gas. Fully double glazed. Economy 7 heating.

Area Map

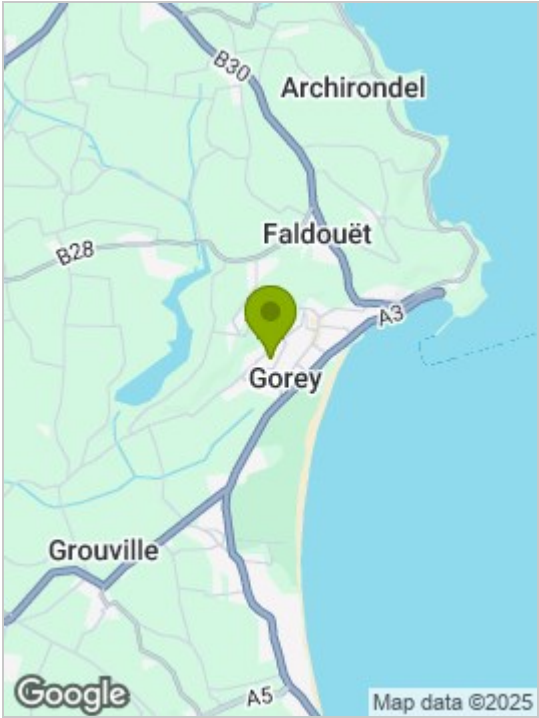

Floor Plan

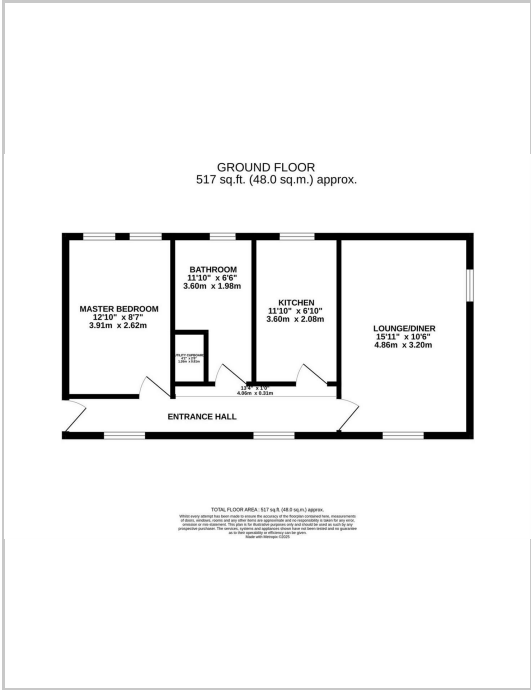

Energy Efficiency Graph

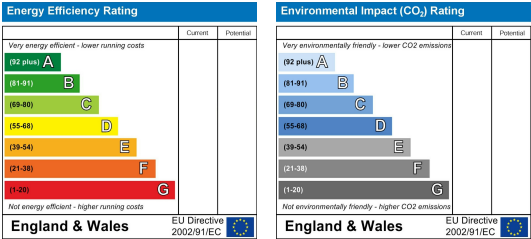

These particulars, whilst believed to be accurate are set out as a general outline only for guidance and do not constitute any part of an offer or contract. Intending purchasers should not rely on them as statements of representation of fact, but must satisfy themselves by inspection or otherwise as to their accuracy. No person in this firms employment has the authority to make or give any representation or warranty in respect of the property.